

# RAMMER RMP18R MULTIPROCESSOR



## SPEED VALVE

Shorter working cycles increase productivity

## DESYNCHRONIZED JAWS

Easier positioning in difficult situations which increases productivity

## FOUR DIFFERENT JAWS DESIGN

Enabling it to work on primary and secondary demolition as well as processing scrap for recycling purposes

## REPLACEABLE CUTTING BLADES

Allows inside rebar processing therefore reducing flame cutting needs which reduces o&o costs

## MANUFACTURED FROM HB400 STEEL

Highly resistant material to work on concrete

## HYDRAULIC ROTATION WITH PROTECTION VALVE

The protected rotation system allows precision tool placement, lowering/reducing owning and operating costs.

## RMP MULTIPROCESSORS

Rammer's RMP Multiprocessors range is a versatile range of products suited for both primary and secondary demolition applications. This hydraulic attachment consists of a main structure, to which it is possible to mount different types of jaws transforming the RMP Multiprocessor into a dedicated attachment for your application: demolition of structures, reduction and fragmentation of material up to the cutting of ferrous materials.

**Ram  
mer®**

# RMP18R

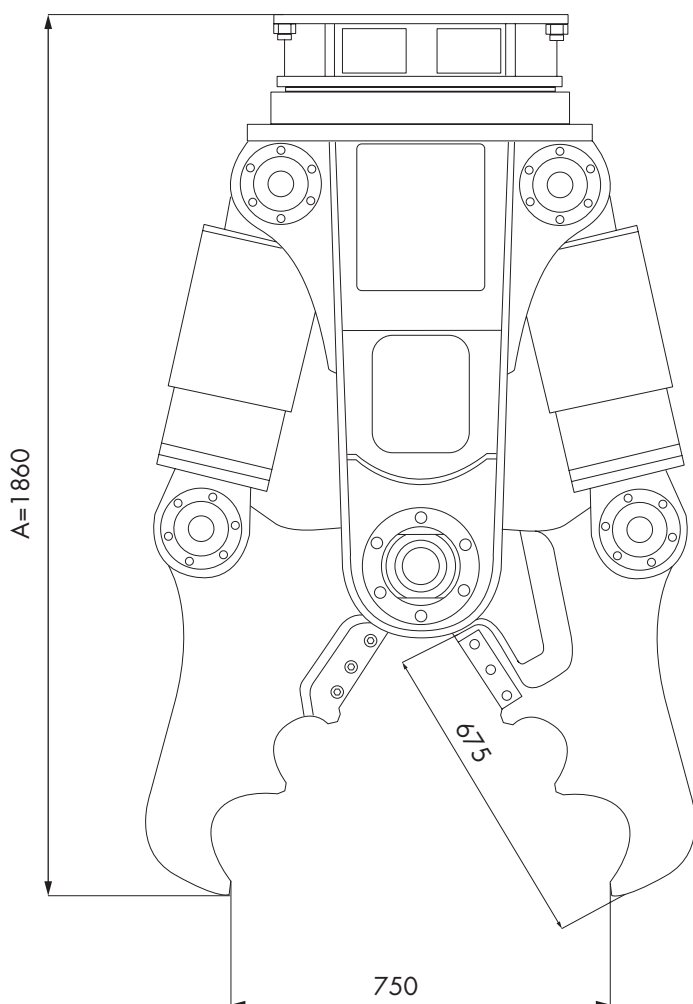

## SPECIFICATIONS

Working weight, kg (lb)	1860 (4100)
Operating pressure, bar (psi)	320 - 350 (4640 - 5075)
Oil flow, l/min (gal/min)	130 - 150 (34.3 - 39.6)
Rotation operating pressure, bar (psi)	90 - 100 (1305 - 1450)
Rotation oil flow, l/min (gal/min)	30 - 40 (7.9 - 10.6)
Cutting blade length with crusher jaws, mm (in)	160 (6.30)
Cutting blade length with pulverizer jaws, mm (in)	160 (6.3)
Cutting blade length with shear jaws, mm (in)	200 (7.87)
Cutting blade length with combi jaws, mm (in)	320 (12.6)
Carrier weight, t (lb)	16 - 20 (35300 - 44100)

ORDER CODE  
K01RMP18R

Crusher jaw set  
581376

Pulverizer jaw set  
581377

Shear jaw set  
581378

Combi crusher  
jaw set  
581668

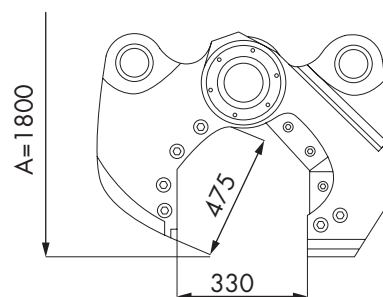
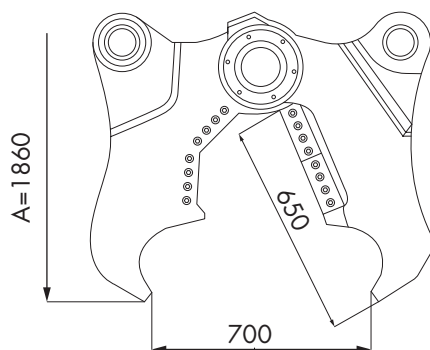
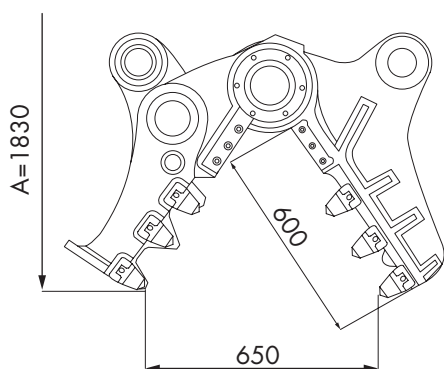
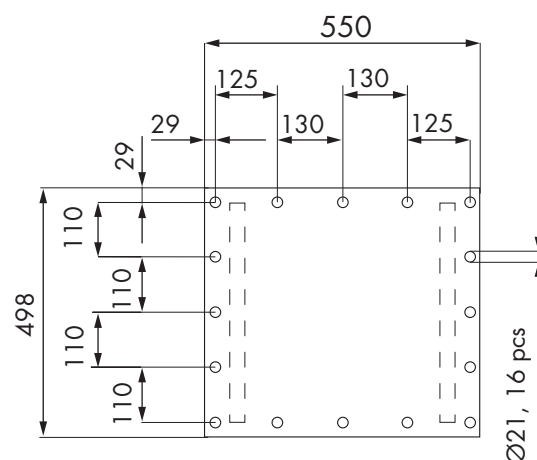

Sandvik Mining and Construction Oy  
Taivalkatu 8, P.O.Box 165  
FI- 15101 Lahti, Finland  
Phone Int. +358 205 44 151  
[www.rammer.com](http://www.rammer.com)

**Ram  
mer®**